



SUPERSCOOP MK 4.5

INSTALLATION & MAINTENANCE

TC41910

Parts List

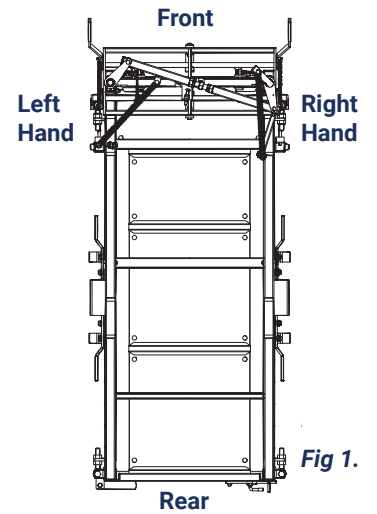
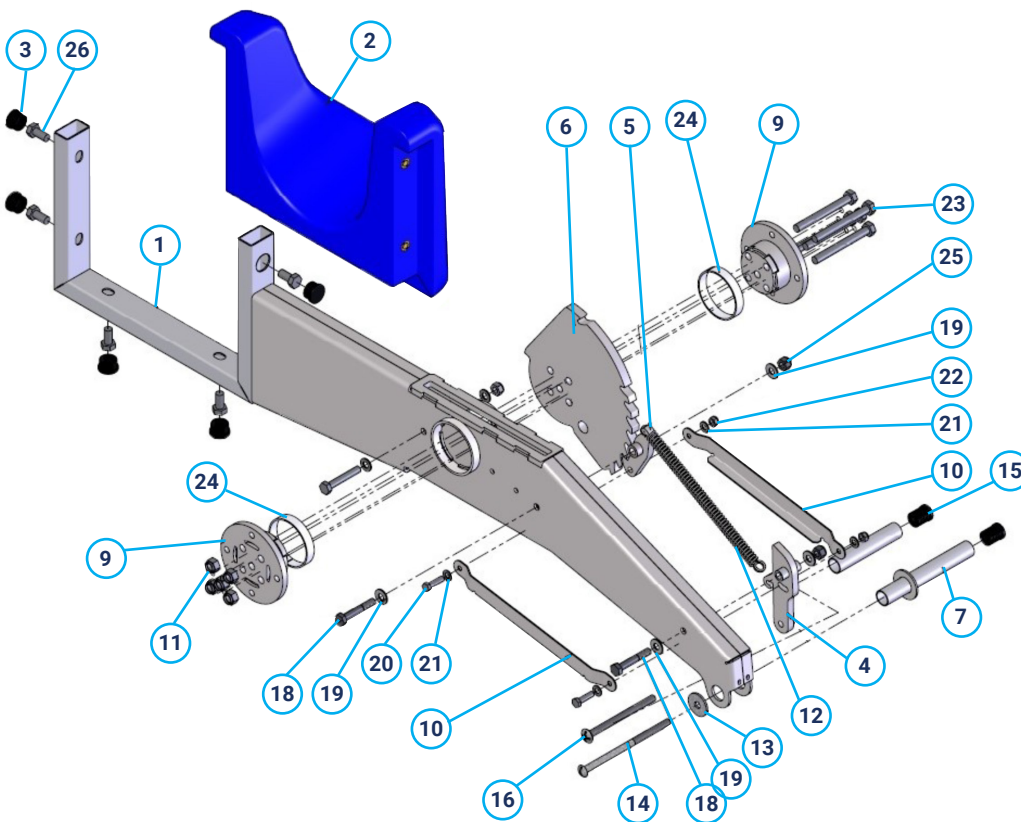

Before attaching the Superscoop:

- Check which hand you need your Superscoop to be.
- Read the manual thoroughly to familiarise yourself with the assembly process.
- Check all fittings are present
- Note that the handing of the Superscoop will be as Fig 1.

Ref No.	Description
1	1426L X287H SUPER SCOP ARM
2	DARK BLUE SCOOP HEAD MOULDING
3	31.7 X 1.25-1.5 WALL BLK PLASTIC INSERT
4	HR SHT 12 RATCHET LEVER
5	HR SHT 10 RATCHET PAWL
6	HR SHT 15.0 273 X 225 LASER CUT
7/8	CHS 25X1.5 TUBE HANDLE
9	CENTRE BOSS AND BOLT FIXING FLANGE
10	GALV SHT 2 349.3X40.4L BTF
11	M12 NYLOC NUT TYPE T BZP
12	EXTEN SPRING 28DX196ULX2.6 WIRE
13	M10 FORM G REPAIR WASHER BZP
14	M10 X 180 ROOFING BOLT ONLY GALV

Ref No.	Description
15	M10 BLACK NYLON - METAL THREADED INSERT
16	M10 X 140 ROOFING BOLT ONLY GALV
17	M10 WASHER (FORM E)
18	M10 X 65 BOLT GALV
19	M10 WASHER (FORM F) GALV
20	M8 X 30 SETSCREW BZP
21	M8 WASHER FORM E
22	M8 FULL NYLOC NUT TYPE T BZP
23	M12 X 110 BOLT BZP
24	PTFE BEARING TAPE 245L X 14.8W X 2.3 THK
25	M10 FULL NYLOC NUT TYPE T GALV
26	M12 X 25 SETSCREW BZP
27	M10 X 65 BOLT BZP

Ref No.	Description
28	M10 FULL NYLOC NUT TYPE T BZP



Health and Safety
Stages of the installation may require the use of personal protection equipment.

Installation on a Chieftain crush

Prior to installation, the relevant side panel must be removed from the crush on the side where the Superscoop is to be attached (Fig 2).

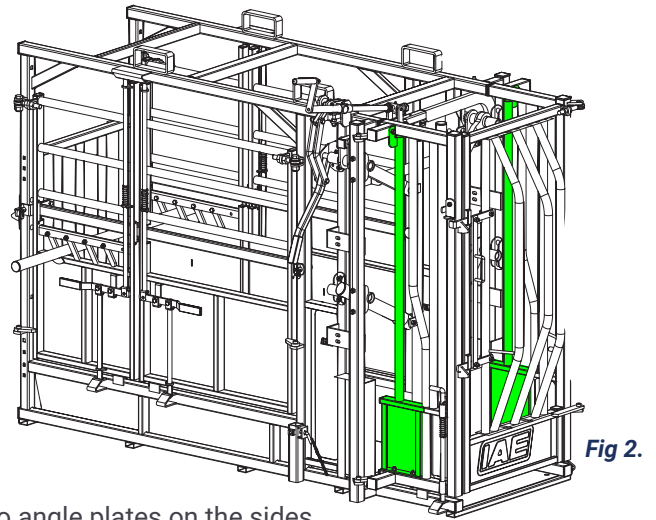

Fig 2.

Locate the 4no angle plates on the sides of the Chieftain crush. These have 2no slots to which the fixing arms will be attached (Fig 3).

The Superscoop is factory supplied to fit to the brackets on the right hand side of the crush. The hand of the Superscoop can be changed by following the guide on page 4 of this manual. These illustrations show a right hand installation.

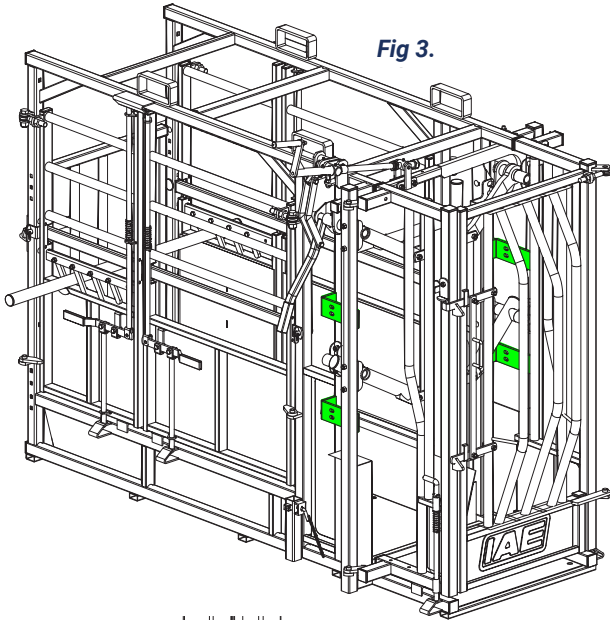

Fig 3.

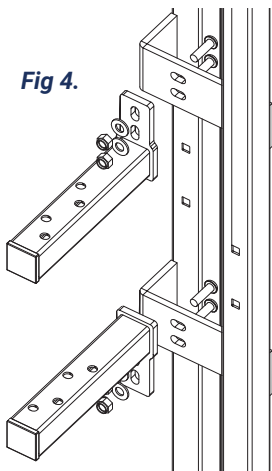

Fig 4.

1. Fix the arms to the bracket on the crush using 4no M12 x 40 socket button head screws (Fig 4). Do not tighten the bolts at this stage.

2. Fix the channel onto the arms using 4no M12 x 80 bolts in conjunction with the drilled plates. Be sure to use the 2no holes nearest the crush (Fig 5).

All bolts may now be tightened.

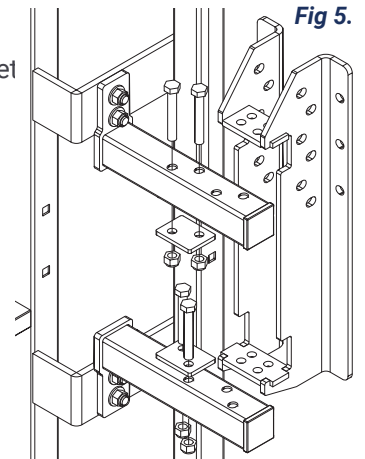

Fig 5.

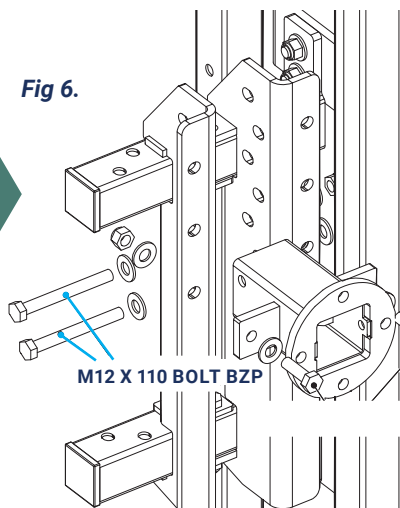

Fig 6.

3. Fix the Superscoop bracket to the channel using 2no M12 x 110 bolts and 2no M12 x 40 setscrews (Fig 6). The height of the Superscoop arm can be adjusted by using the other available holes (see page 5).

4. Check that the Superscoop has been adjusted so that it is the correct hand.

Offer the Superscoop up to the bracket making sure that the 4no fixing holes line up.

Fix the Superscoop to the bracket using 4no M12 x 25 socket button head screws (Fig 7).

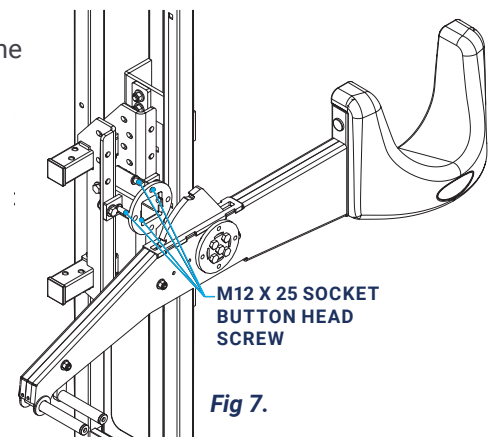

Fig 7.

Installation on a Saracen crush

Locate the 4no holes on the sides of the Saracen crush (2no per side). These are the holes to which the fixing arms will be attached (Fig 8).

The Superscoop is factory supplied to fit to the brackets on the right hand side of the crush. The hand of the Superscoop can be changed by following the guide on page 4 of this manual.

These illustrations show a left hand installation.

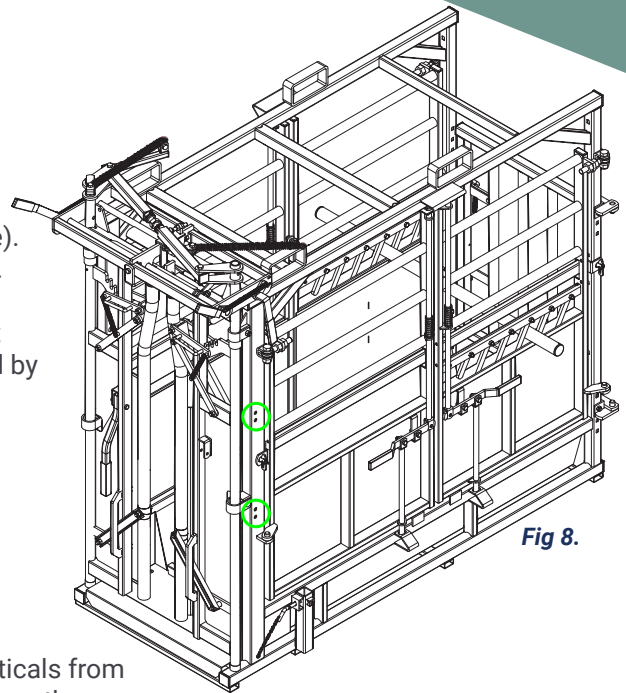

Fig 8.

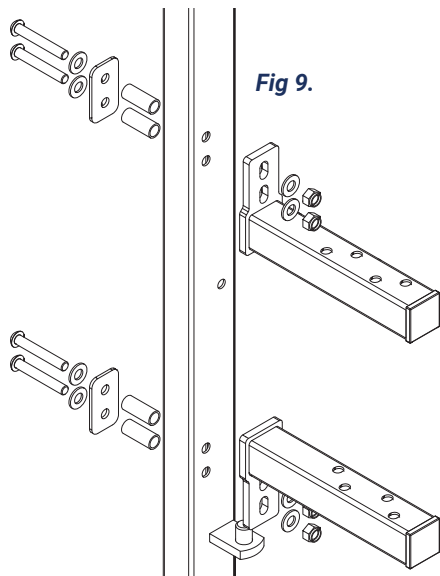

Fig 9.

1. Insert the tubes into the verticals from the inside of the crush then place the drilled plates over the tubes. Fix the arms to the crush using 4no M12 x 90 socket button head screws (Fig9).

Do not tighten the bolts at this stage.

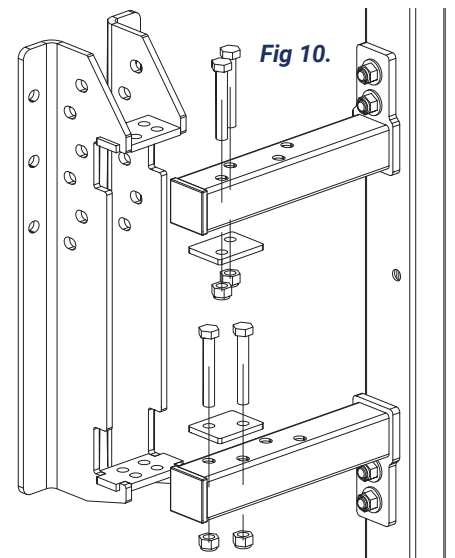

Fig 10.

2. Fix the channel onto the arms using 4no M12 x 80 bolts in conjunction with the drilled plates. Be sure to use the 2no holes furthest away the crush (Fig 10).

All bolts may now be tightened.

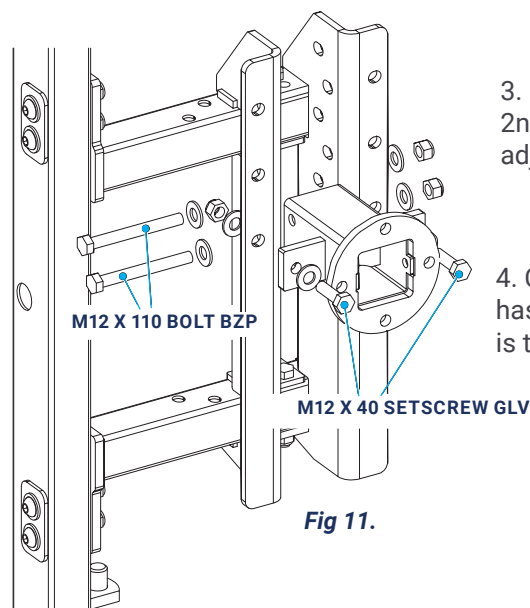

Fig 11.

3. Fix the Superscoop bracket to the channel using 2no M12 x 110 bolts and 2no M12 x 40 setscrews (Fig 11). The height of the Superscoop arm can be adjusted by using the other available holes (see page 5).

4. Check that the Superscoop has been adjusted so that it is the correct hand.

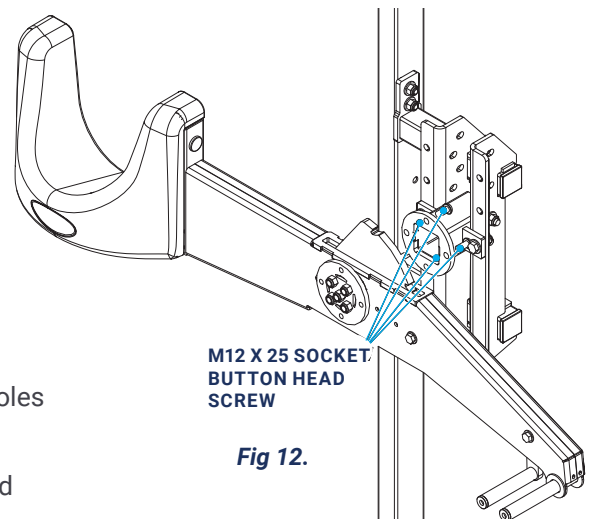

Fig 12.

Offer the Superscoop up to the bracket making sure that the 4no fixing holes line up.

Fix the Superscoop to the bracket using 4no M12 x 25 socket button head screws (Fig 12).

Changing the hand of the Superscoop

All IAE Superscoops are factory supplied to fit to the right hand side of a crush (Fig 1).

The hand of the Superscoop can be changed by following a few simple steps.

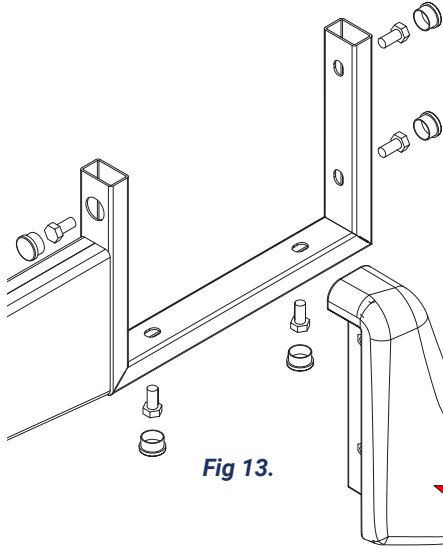

Fig 13.

Remove the 5no plastic inserts from around the head of the Superscoop taking care not to damage the frame.

Remove the 5no M12 x 25 setscrews that hold the scoop head into the frame and remove the scoop head from the frame.

Rotate the scoop head through 180°.

Re-insert the scoop head to the other side of the frame.

Re-fit the 5no M12 x 25 setscrews and tighten.

Insert the 5no plastic caps to cover the setscrews.

Unscrew the 2no bolts that bolt through the handles at the base of the Superscoop arm.

Remove the handles, bolts, washer and nylon threaded inserts.

Reassemble the handles on the opposite side of the Superscoop arm.

Ensure that the bolts are tight before using the Superscoop.

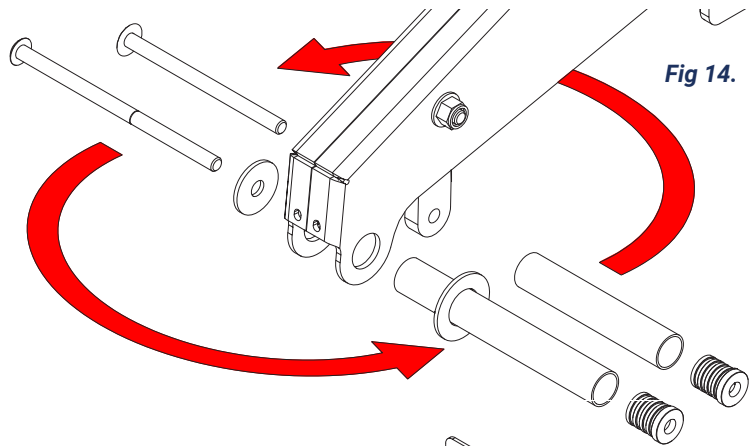

Fig 14.

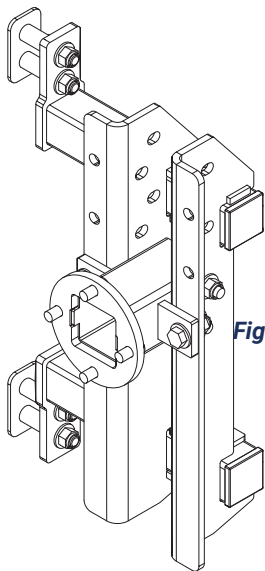

Fig 15.

Saracen L/H setup

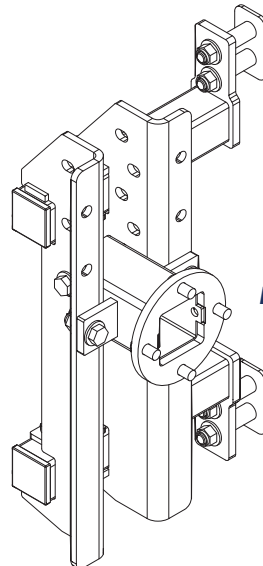

Fig 16.

Saracen R/H setup

Changing the hand of the Superscoop (cont.)

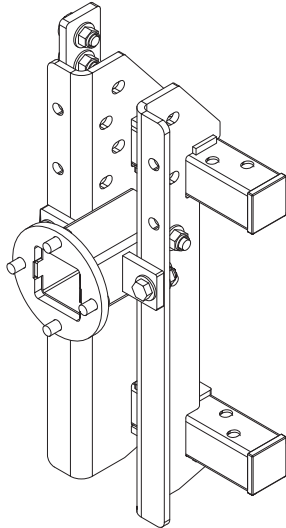

Fig 17.

Chieftain L/H setup

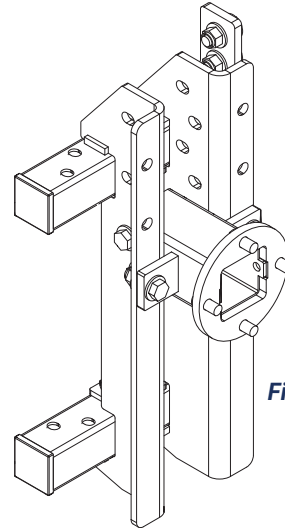

Fig 18.

Chieftain R/H setup

N.B. When removing the Superscoop from a Chieftain crush to reinstall it on the opposite side:

- Reinstall the side panel to the side that the Superscoop is being removed from.
- Remove the side panel from the side that the Superscoop is being installed to.

Adjusting the height of the Superscoop

The height of the Superscoop can be adjusted to suit different breeds and sizes of livestock.

The Superscoop is supplied with three sets of holes to allow the arm to be used at three different heights

The bracket fits to the sides of the channel using 2no M12 x 110 bolts and to the front using 2no M12 x 40 setscrews

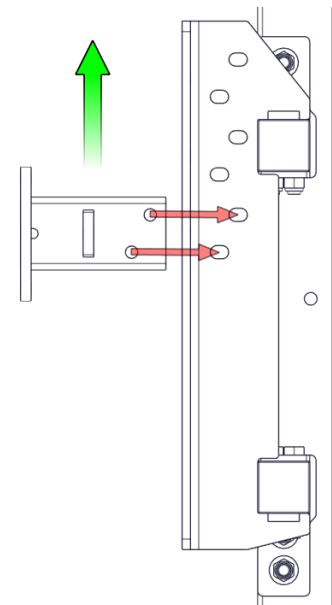

Fig 19.

Maintenance

Although IAE equipment is designed to withstand adverse weather conditions and to withstand prolonged heavy usage, monthly inspections and regular maintenance will help to extend the longevity of the product. The following checklist may be useful:

- Pressure wash at regular intervals.
- Check all over the Superscoop for any loose or missing fittings and tighten/replace as necessary¹.
- Make sure that the Superscoop is bolted firmly in place¹.
- Lubricate all moving parts at regular intervals.

¹ These items should be checked prior to each use